

UIC compatible gangway

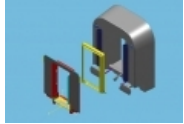

Deutsche Bahn AG



The UIC compatible gangway meets the requirements of the International Union of Railways for gangway systems and therefore enables the coupling to another UIC gangway. This gangway in particular meets the requirements for the so-called "Berne Rectangle", a free space in the floor area which provides enhanced safety for the personnel during the coupling process.

In comparison to the standard UIC gangways it offers enhanced convenience and safety for the passengers, especially effective sealing against shock waves in homogeneously coupled train, improved sound insulation, reduction of thermal losses, no drafts in homogeneously coupled trains and protection of the interior from penetration of break dust, dirt etc.

Sophisticated technology

The technical design ensures outstanding operating characteristics. This is primarily due to the main components: angled frames with end wall sliding seal plates and integrated, up-folding gangway bridge, corrugated bellows as a flexible link between car and gangway, rubber spring elements as load transmitting element to compensate movements and suspension on the car. The sliding seal plates of both gangways press against each other when coupled and ensure protection from outside influences.

A centering system keeps the two gangway halves aligned. By combining centering and rubber spring elements, the diagonal skew of the cars is compensated so that no mismatch between the gangway halves is possible. Rubber spring elements provide the necessary contact pressure in curves and prevent gaps from opening between the two gangway halves. Specially developed corrugated bellows as a connection between the car and the angled frame ensure optimal flexibility and reliability.

[back to gangways](#)